



DANGER

Airbag unit can trigger unintentionally!

Airbag unit is a pyrotechnic component that can lead to death on improper handling!

Only specially trained employees may carry out any work on the airbag system.

Disconnect the battery.

Always store airbag unit with the padded side pointing upward.

Always transport airbag unit in appropriate packaging.

Never leave airbag unit unattended, but lock safely in an appropriate cabinet.

Do not open or repair airbag unit.

Only install airbag unit in undamaged condition.

Do not perform any measurements on the airbag unit using a test lamp or multimeter.

Wear protective gloves and safety goggles.

No person may stay inside the vehicle when re-connecting the battery.

Remove:

Move steering wheel to the centre position and let steering lock engage.

Switch off ignition.

Wait 20 minutes after switching off the ignition.

Disconnect battery (negative terminal).

Keep waiting time of min. 10 min.

Carefully remove gearshift lever cover(s) using a lever and place over gearshift knob. **(1)**

Disconnect electric connectors.

Unscrew cover screw(s). **(2)**

Remove cover(s) at side of dashboard. **(3)**
(see Figure 1)

Figure 1

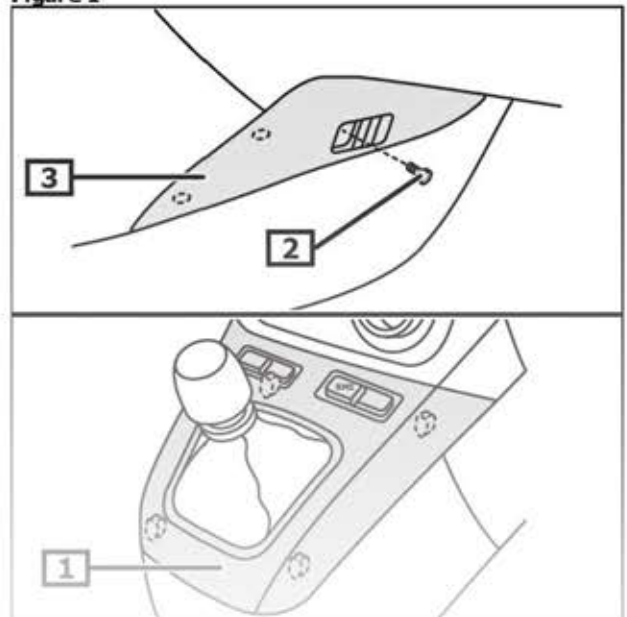

1 Gearshift lever cover(s)

2 Cover screw(s)

3 Cover(s) at side of dashboard

This document is no longer available on Tech Corner. In order to view this and other content, register now for ZF Services [pro]Tech. More information and the registration form can be found under the following link:

<https://protech.zf.com>

