

REVISIONS & MODIFICATIONS				SIGNATURE
REV	DATE	R.d.M.	DESCRIPTION	

OE#TAKEN AS REFERENCE: BCA-26-43Z		
BILL OF MATERIALS & COMPONENTS		
Nº	FT CODE	DESCRIPTION
Q.TY		
1	FT#C	Friction compound for passenger cars
– Friction material: 11		
– Identification letter: C		
– Friction coefficient: according to ISLB-28		
– Shear resistance: according to ISLB-17		
– Compressibility: according to ISLB-30		
– Density: according to ISLB-19		
– Hardness: according to ISLB-18		
– Friction material surface: 2.543,6 mm²		
– General tolerances: ±0,5		
2	FT#U	Underlayer compound
– Identification letter: U		
– Color: black or red		
– Friction coefficient: according to ISLB-28		
– Shear resistance: according to ISLB-17		
– Compressibility: according to ISLB-30		
– Hardness: according to ISLB-18		
PAD TH ≤ 10mm --> FT#U TH MAX= 2,5mm		
PAD TH ≤ 10mm --> FT#U TH min= 1,5mm		
10mm < PAD TH < 24mm --> FT#U TH MAX= 3,5mm		
10mm < PAD TH < 24mm --> FT#U TH min= 2mm		
PAD TH > 24mm --> FT#U TH MAX= 4,5mm		
PAD TH > 24mm --> FT#U TH min= 3mm		
3	C.85.53	Frt-coating water based adhesive
– Color: black		
– Shear resistance: according to ISLB-17		
Plate surface ≤ 100cm² --> 2,50mg/cm² ± 5,50mg/cm²		
Plate surface > 100cm² --> 8,50mg/cm² ± 11,00mg/cm²		
4	MC.002	Powertr. point
– Color: black		
Thickness = 40 ± 90 µm		
ALL THE DIMENSIONS EXPRESSED IN THE DRAWING DON'T CONSIDER THE THICKNESS OF THE PAINT		
5	PM.1066	Backing plate
– Plate material: S235JR		
– Plate surface: 3.579,1 mm²		
– General tolerances: ±0,3		
– Roughness:		
Ra ≥ 7 µm		
Rz ≥ 45 µm		
5	PM.1066A	Backing plate
– Plate material: S235JR		
– Plate surface: 3.651,1 mm²		
– General tolerances: ±0,3		
– Roughness:		
Ra ≥ 7 µm		
Rz ≥ 45 µm		
6	ML.238K	2x acoustic sensor
– Spring material: steel 65Mn		
– Surface treatment: degreasing		
7	ML.340	Acoustic wear sensors
– Spring material: steel 65Mn		
– Surface treatment: degreasing		
8	AV.843	Anti-noise shim
– Spring material: multilayer rubber-steel-rubber		
– Surface treatment: smooth		
9	AV.844	Anti-noise shim
– Spring material: multilayer rubber-steel-rubber		
– Surface treatment: smooth		

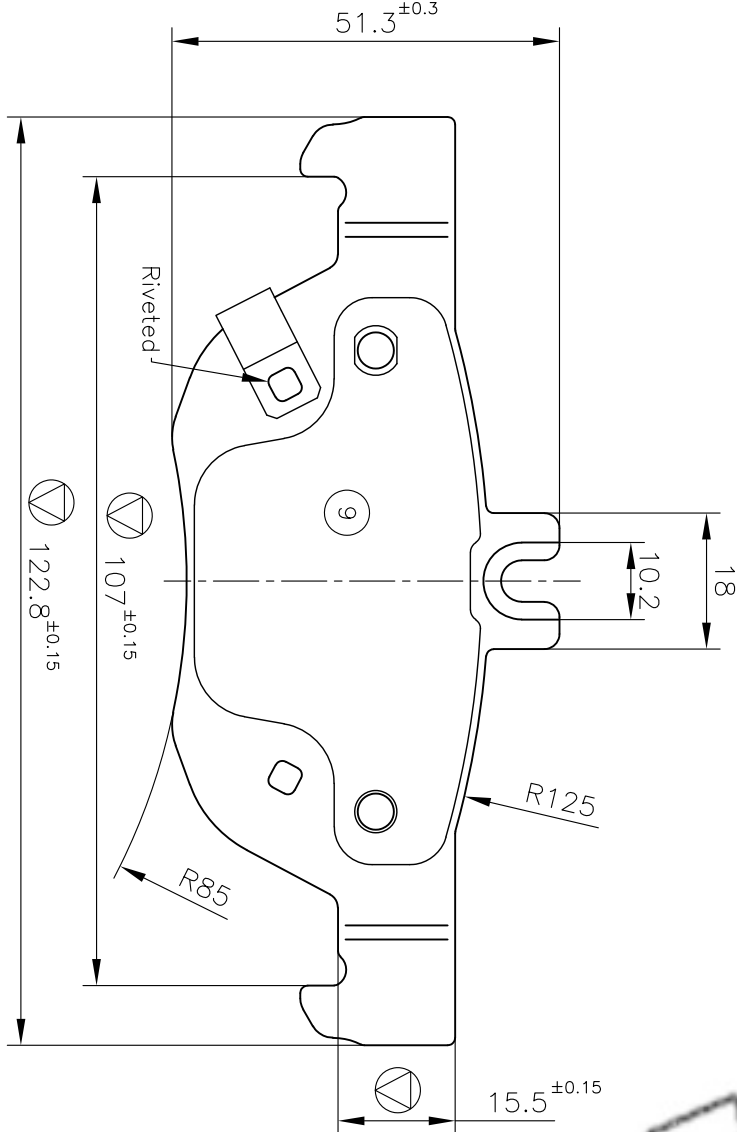

Rear View

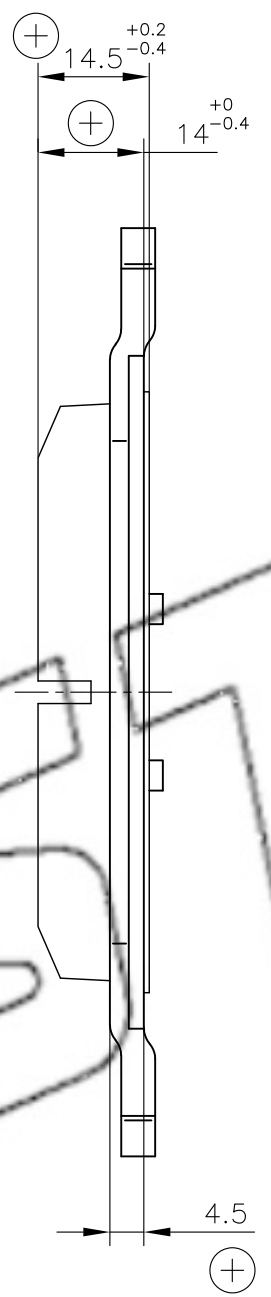
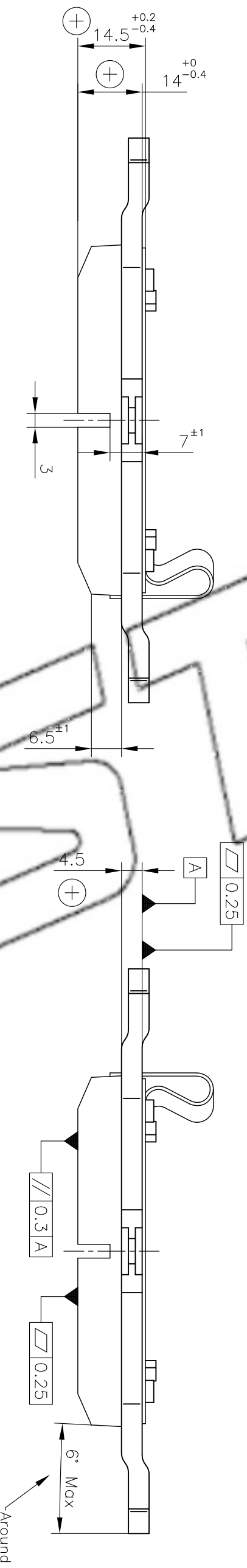
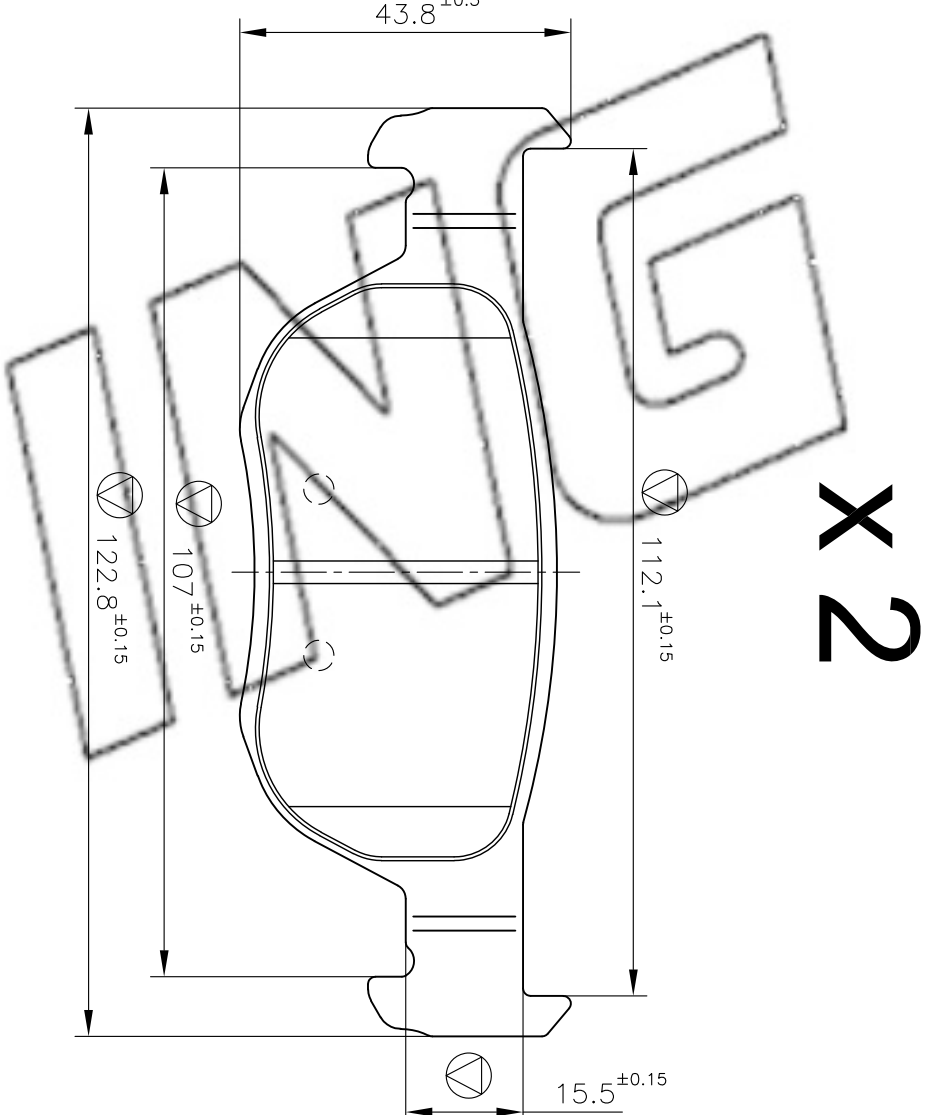
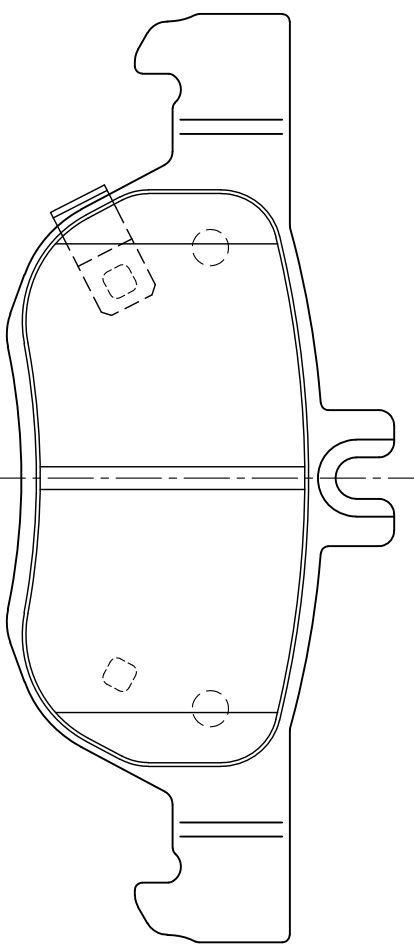
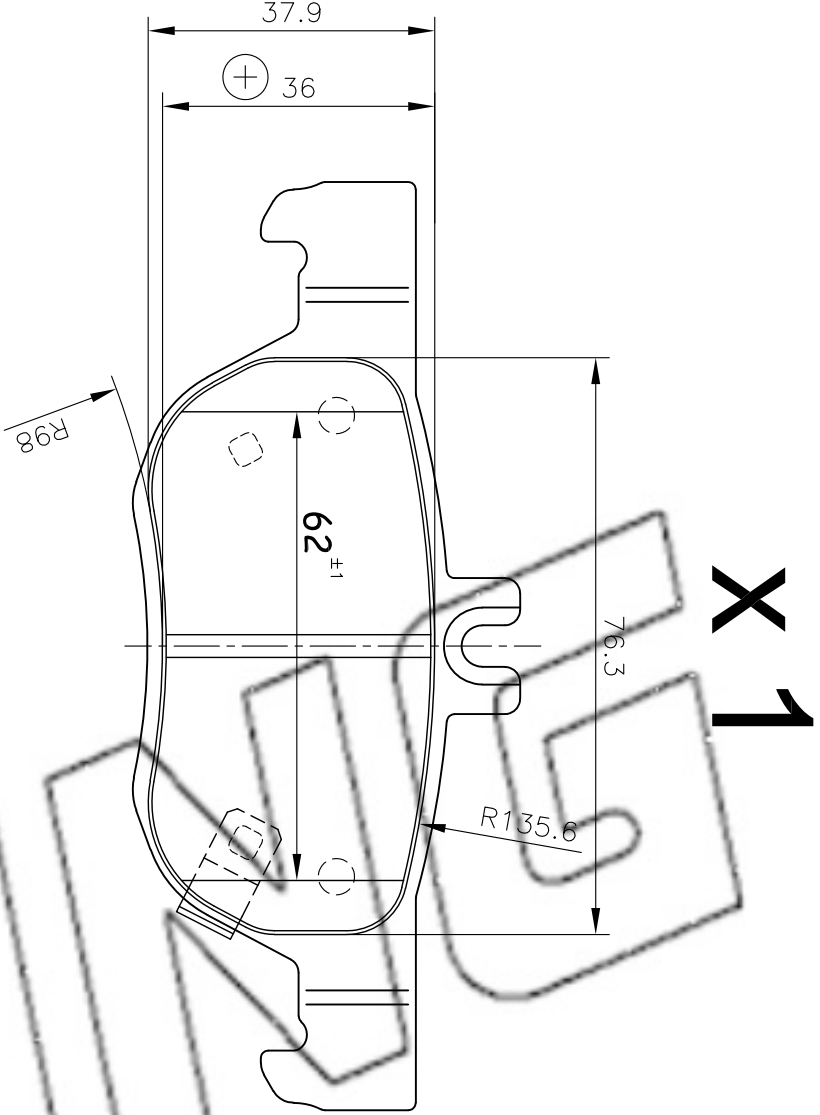
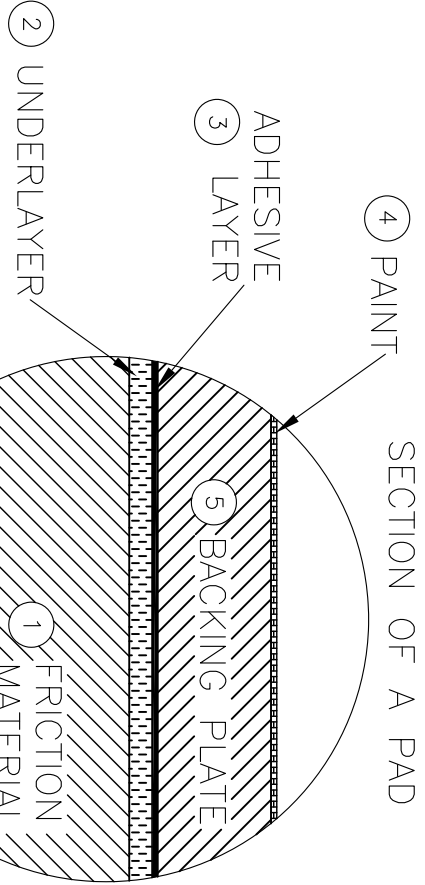
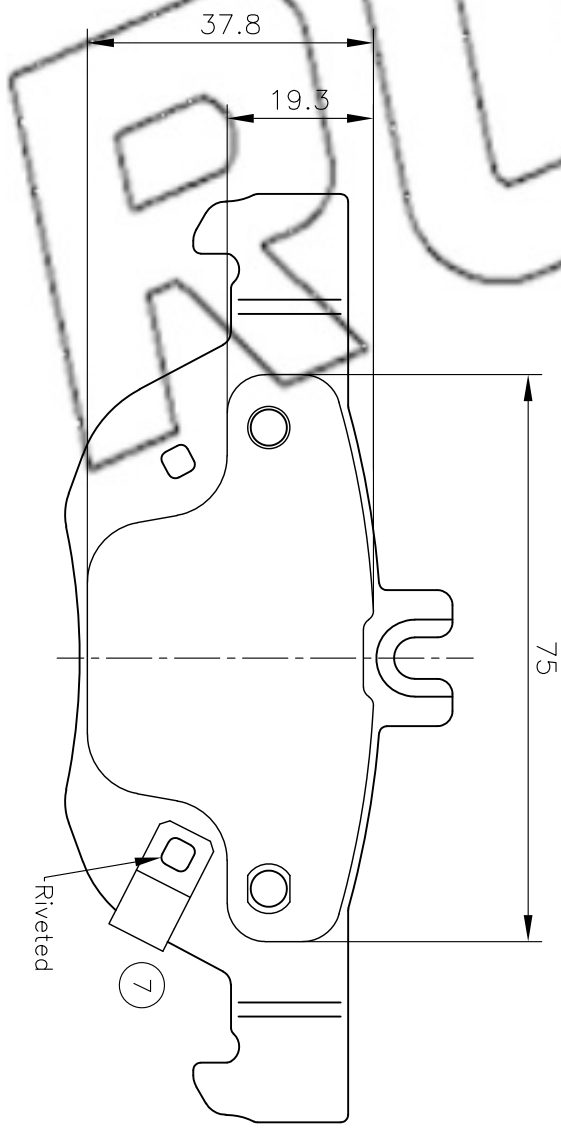

Rear View

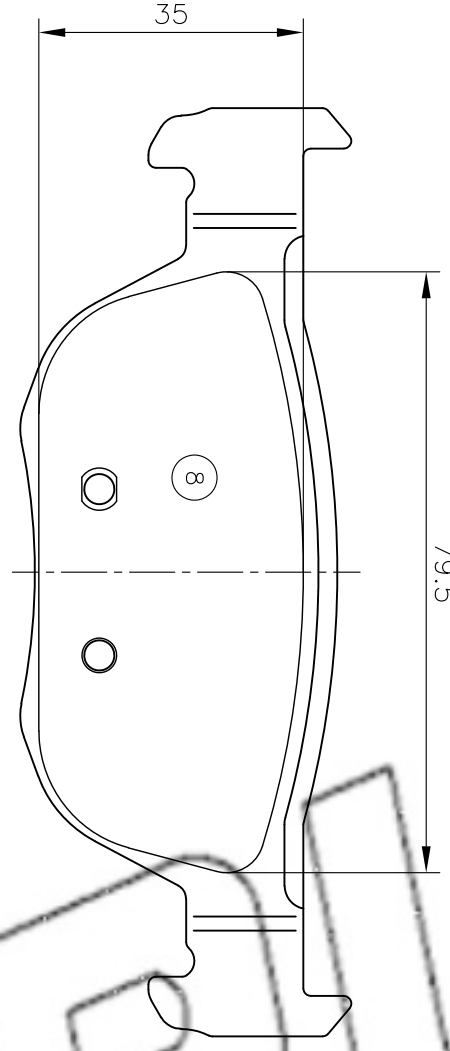

Rear View

KIT INCLUDED WITH THE PADS SET

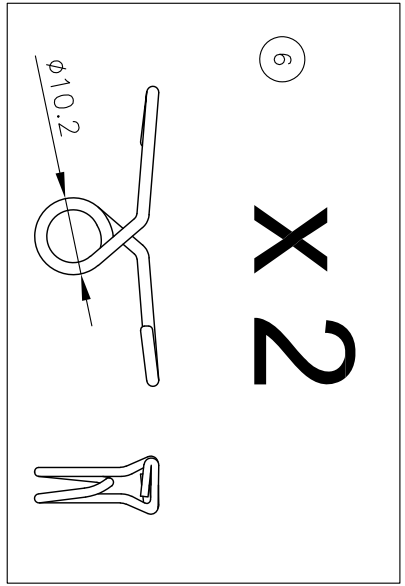

CRITICALITY LEGEND				
REPORT	12	CRITICAL	7	IMPORTANT
CAD DRAWING – MANUAL MODIFICATIONS ARE NOT ALLOWED				
Part name	BRAKE PADS			Prod. class 1D
Reference Code	1226.0			
Signature	Date		Draw. N° 5.5.35	Scale 1:1
Drawn	Castellino A. 22.01.2021		Size A1	
Approved	Bolocco E. 22.01.2021			
Verified	Chieschio M. 22.01.2021			
Description	COMPLEX PROJECT DRAWING			
				