

FITTING INSTRUCTIONS

CITROEN XSARA PICASSO 2000-2010

TCI 129 101067

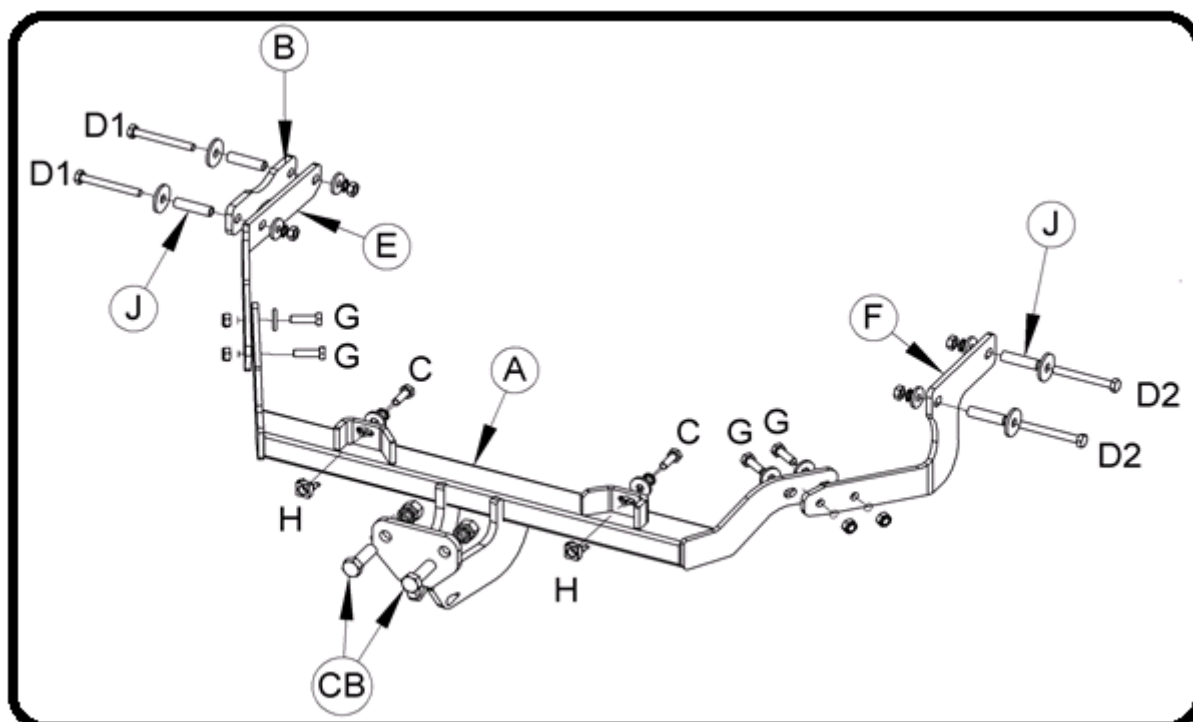

MATERIALS

A	1	Cross Bar with European facing to 94/20/EC A50-1
B	1	Chassis Spacer Bush (Left side only)
C	2	M10 x 35 x 1.5mm Bolts, Lock Washers and Flat Washers (25mm O.D.)
D1	2	M10 x 100 Bolts, Nuts, Lock Washers, Flat Washers x4(30mm O.D.) and Large Flat Washers (40mm O.D.)
D2	2	M10 x 90 Bolts, Nuts, Lock Washers, Flat Washers (30mm O.D.) and Large Flat Washers (40mm O.D.)
E	1	Left Hand Side Arm
F	1	Right Hand Side Arm
G	4	M10 x 35 x 1.5mm Bolts, Flat Washers (25mm O.D.) and Nyloc Nuts.
H	2	Nut Retainers and M10 x 1.5mm Square Nuts.
J	4	Bushes (14mm O.D. x 54mm Long)
CB	2	M16 x 50 x 2.0mm Coupling Bolts, Nuts and Lock Washers

FITTING

1. Remove spare wheel. Lower rear exhaust hanger if necessary. Insert Bushes (J) into frame from outside faces.
2. Loosely attach Side Arms (E) and (F) to chassis using Bolts (D1 & D2). Ensure chassis spacer (B) is used on left side. Use extra 30mm washers on threads should they be required.
3. Insert captive fasteners (H) onto top of crossbar (A) and fit to rear panel mountings using Bolts (C). *Note: It is advisory to open up rear panel mounts for Bolts (C). Attach Cross Bar (A) to Side Arms (E) and (F) using Bolts (G).*
4. Push face plate to its highest position and tighten all bolts to recommended torque. Re-mount exhaust hanger and spare wheel.

Note: This towbar must be used with either a Class A50-1 or A50-X towball, which dimensionally conforms to A50-1 with a 'D' and 'S' value greater than or equal to that of the towbar.

Recommended torque settings: Grade 8.8 bolts: M8 - 24Nm, M10 - 52 Nm, M12 - 80 Nm, M14 - 130 Nm, M16 - 200 Nm
Grade 10.9: M12 - 120Nm, M10 - 70Nm M8- 35Nm