

FITTING INSTRUCTIONS
NISSAN NAVARA WITH STEP BUMPER
JULY 2005 –
TNI031 101161

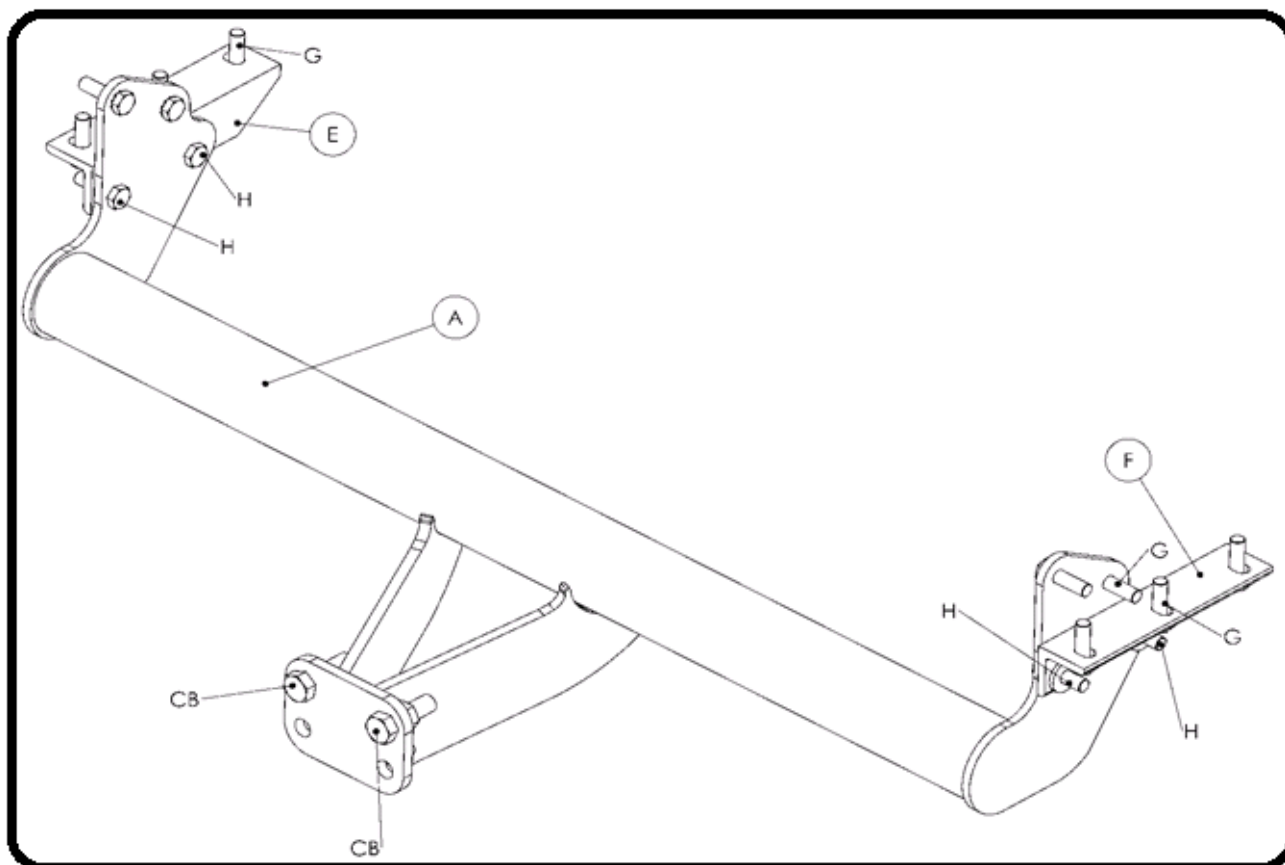

MATERIALS

A	1	Cross Bar with European facing to 94/20/EC A50-1
B	1	10mm Coupling Packer
E	1	Left hand angle cleat
F	1	Right hand angle cleat
G	10	M12 x 40mm x 1.25mm Bolts, Lock Washers and Flat Washers
H	4	M12 x 35mm x 1.75mm Bolts and Nyloc Nuts and Flat Washers
CB	2	M16 x 50mm Coupling Bolts, Nuts, Lock Washers

FITTING

1. Remove and discard towing eye and bolts.
2. Loosely attach Cross Bar (A) and Angle Cleats (E) and (F) to chassis using Bolts (G) and (H).
3. Fully tighten bolts. Coupling packer (B) should be used when towball is fitted to lower set of holes.

Note: This towbar must be used with either a Class A50-1 or A50-X towball dimensionally Conforming to A50-1 with a 'D' and 'S' value greater than or equal to that of the towbar. Please refer to the vehicle specification for the trailer weight and nose limits, which must be observed.

Recommended torque settings: M8 - 27Nm, M10 - 53 Nm, M12 - 95 Nm, M14 - 150 Nm, M16 - 214 Nm