

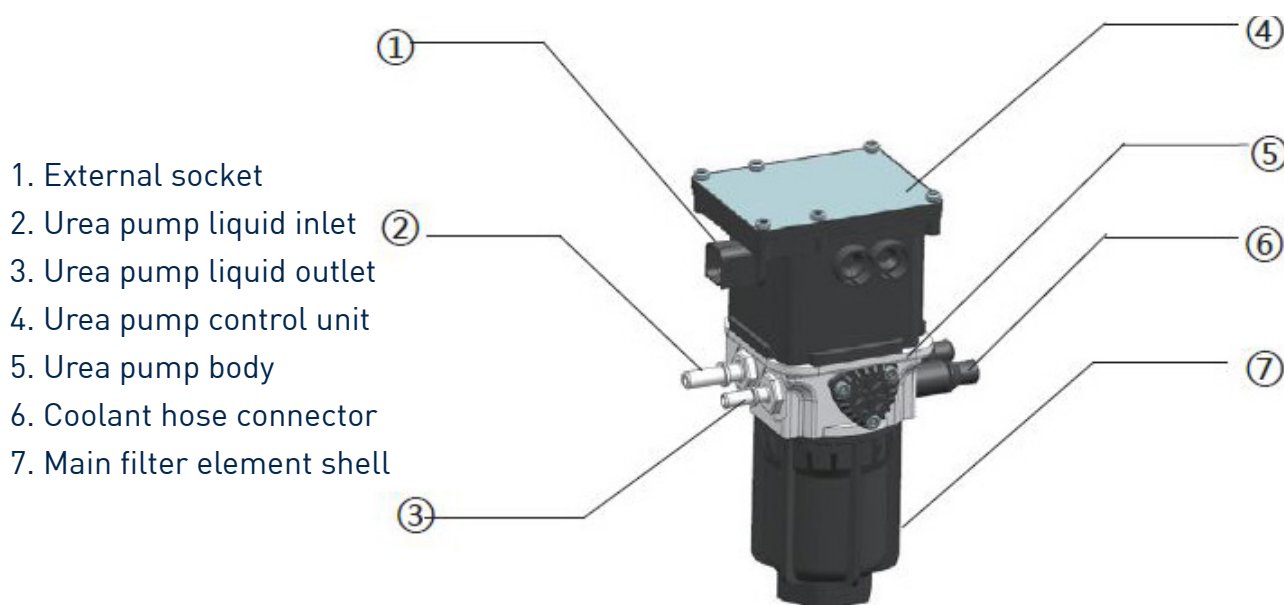

Urea Pump

Product Description

The urea pump is a key component of the automotive aftertreatment system. Its main function is to extract the urea solution in the urea tank and maintain a certain pressure and then transport it to the urea injection unit to meet the requirements of the aftertreatment system on the flow and pressure.



Installation Preparations

When installing a new urea pump, pay attention to the cleaning of the urea pump and related pipelines. In order to prevent foreign matter from entering the urea pump, please use an air gun (air pressure: $P < 6$ bar) at the urea liquid inlet, and continue blowing for more than 3 seconds to clean.

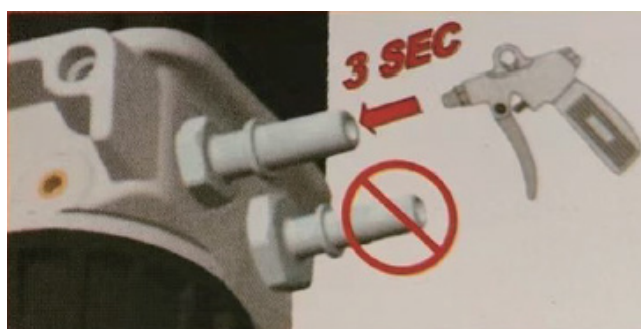



Urea Pump

Connecting Urea Solution Inlet/Outlet Pipes

Be careful to identify the urea solution inlet and outlet. The urea solution inlet is thicker ($\varnothing 8\text{mm}$) and the urea solution outlet is thinner ($\varnothing 7\text{mm}$).

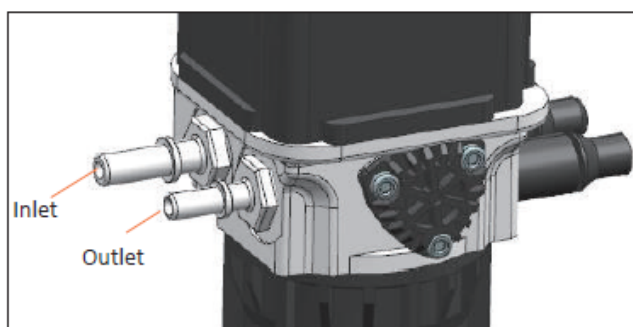

Connecting the Coolant Pipe

To prevent foreign matter from entering the coolant, use an air gun (air pressure: $P < 6\text{ bar}$) to aim at the coolant fitting and blow continuously for more than 3 seconds to clean it. When connecting the coolant of the vehicle to the coolant fitting of the urea pump, keep the piping smooth without having to differentiate between the inlet and outlet ports, and lock the fitting to prevent loosening.

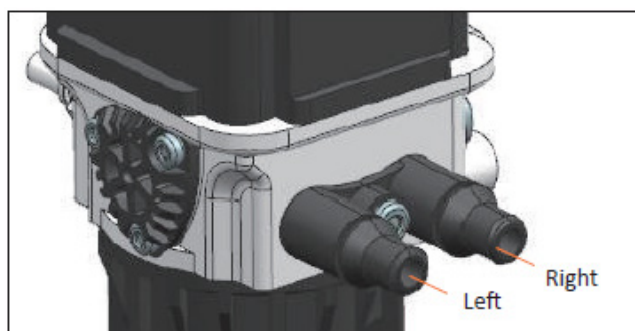



Urea Pump

Connecting Cables

The urea pump uses a 24V vehicle-mounted DC power supply. When installing, you need to identify the function and insertion direction of the connector plug and take care to keep the connector port clean and waterproof.

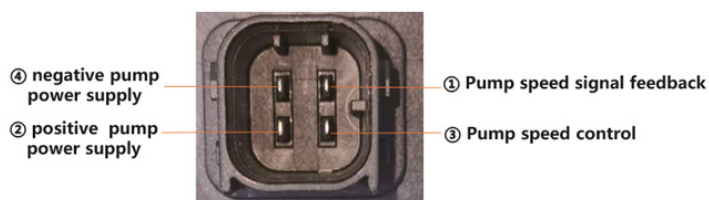

Loading of urea pump

After the relevant pipelines are connected, use M8 flange screws to fix the urea pump on the frame, and the torque is $20 \pm 20\%$ (N•m).

After the installation, ensure that the pipelines are smooth and the connectors are installed in place without loosening.

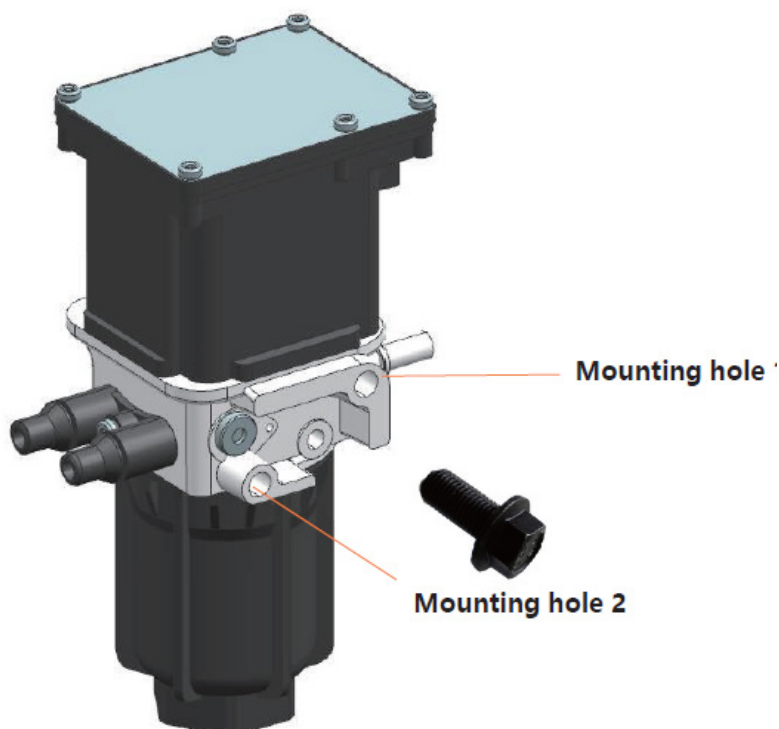



Urea Pump

Notes

When the urea pump is installed and used for the first time, the urea pump may not be able to build pressure smoothly, because there is a large resistance in the injection system pipeline, resulting in the area pump can not discharge air smoothly, preventing the urea pump from completing the function of inhaling urea solution and establishing pressure in the pipeline. Disposal method:

→ Under normal circumstances, the system automatically stops after 2 minutes of operation and the fault can be eliminated by restarting once.

→ When the restart still can not build pressure, you can use a syringe to inject about 80ml AdBlue or distilled water from the urea liquid inlet, reinstall and start the car, you can discharge the fault.

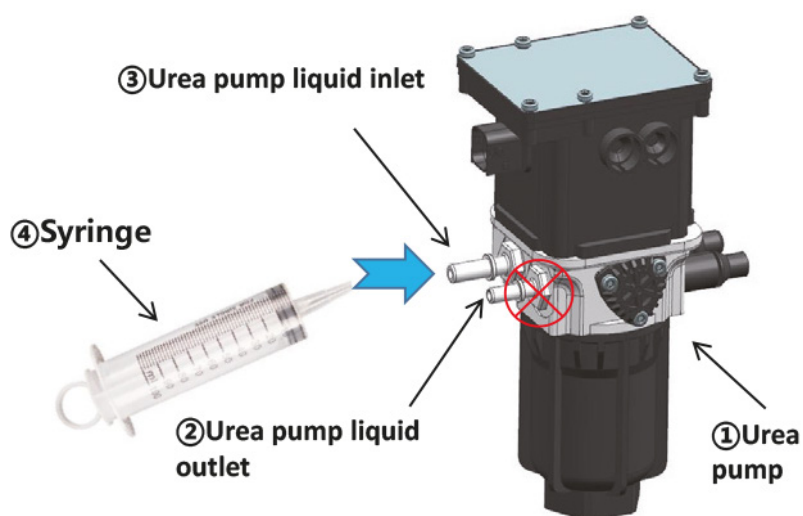

Keep away from the high-temperature exhaust pipe, the distance between them should be more than 30cm, so that the plastic shell will not be deformed by the high temperature.