

FITTING INSTRUCTIONS

MITSUBISHI L200 SU and Fiat Fullback Pickup

Double Cab and Club Cab

TM1039

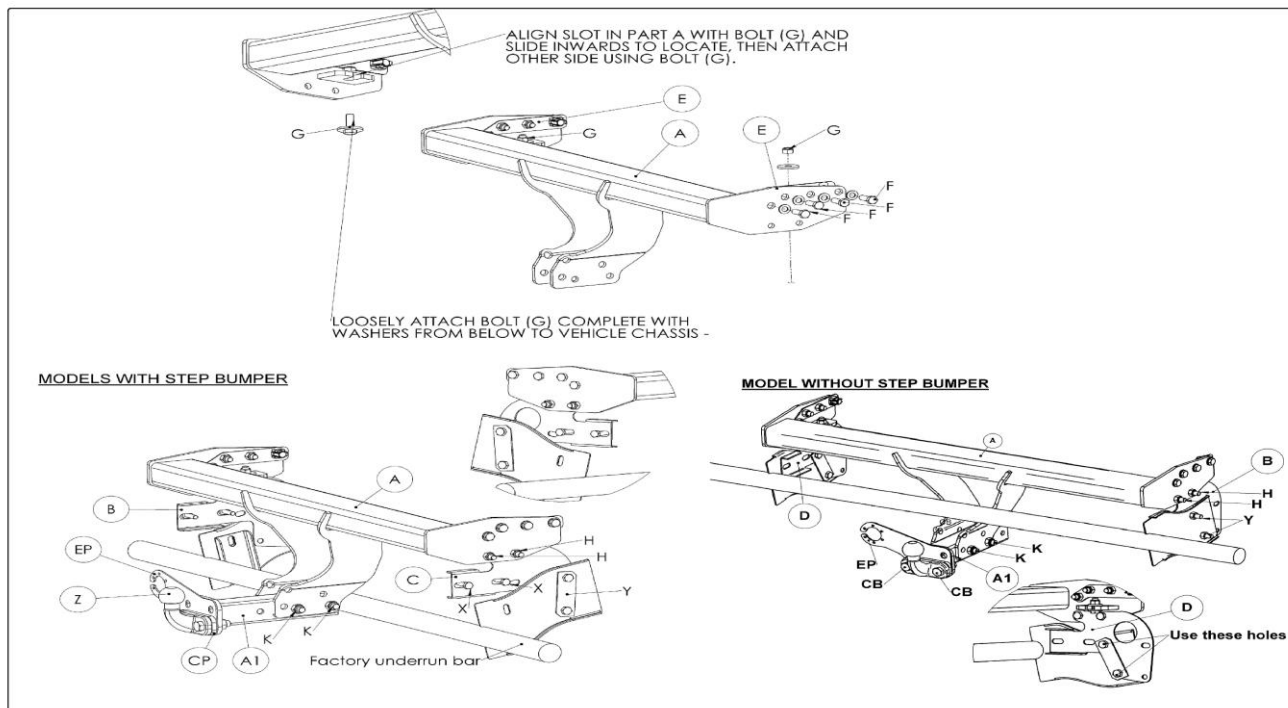

MATERIALS

A	1	Cross Bar
A1	1	Ball support
B	1	Bumper support bracket (large hole in plate)
C	1	Bumper support bracket
E	2	Captive nut strap
F	8	M12 x 40 x 1.75mm Bolts, 6 Nyloc Nuts, 8 Flat Washers (25mm O.D) and 2 Nut Retainers with Square Nuts.
G	2	M12 x 35 x 1.75mm Bolts, Nyloc Nuts and 4 Flat Washers (30mm O.D)
H	4	M12 x 35 x 1.75mm Bolts, and Nyloc Nuts
K	2	M14 x 100 x 2.0mm Bolts and Nyloc Nuts
X	4	Existing M12 fine pitch bolts
Y	2	Existing captive strap with Nuts
CB	2	M16 x 60 x 2.0mm Coupling Bolts, Nuts, Lock Washers and 10mm coupling spacer
EP	1	ZEP 6 – High Clearance electrical plate

FITTING

Refer to sketch – fitting part A

- Step Bumper models – remove bumper from side supports (2 bolts each side – retain bolts (X)), remove black tubular bar from chassis (2 bolts each side)
- Stainless steel and black tubular bar models-remove the bolts securing it to the vehicle chassis and retain bolts (Y).
- Attach Cross Bar (A) to bottom face of chassis using Bolts (G) with Flat Washers fitted inside chassis and below, due to the weight of the assembly it is advisable to hold one end using a suitable support.
- Assemble cage Nuts (E) as shown on separate fitting instruction to Nut Straps (E). Loosely attach Cross Bar (A) and the Stainless Steel bumper (where fitted) to existing holes (F) in the chassis with Nut Straps (E) fitted inside chassis and Bolts (F) with Flat washers fitted outside.
- Fully tighten all bolts

Refer to sketches – Step Bumper and Models without Bumper

- Attach bumper support brackets (B) and (C) to inside face of Cross bar (A) using bolts (H).
- Where fitted slide the Step Bumper into position and attach to the Support Brackets (B) and (C) using Original Bolts (X).
- Attach underrun bar to support brackets using original fixing plates (Y) see correct sketch for position.
- Attach Ball Support (A1) using Bolts (K)
- Fully tighten all bolts.

Note: This towbar must be used with a Class A50-1 or A50-X towball, which dimensionally conforms to A50-1 with a 'D' and 'S' value greater than or equal to that of the towbar.

Recommended torque settings: Grade 8.8 bolts: M8 - 24Nm, M10 - 52 Nm, M12 - 80 Nm, M14 - 130 Nm, M16 - 200 Nm
Grade 10.9: M12 - 120Nm, M10 - 70Nm M8- 35Nm