



Fitting Instructions

TOWBAR
For Nissan X-TRAIL
For use with 2039 Series
necks

DT131AU For
DT131A, DT131AS
DT131AQ &
DT131AQF

MATERIALS

A	1	Cross Bar
D	1	Left hand sidearm
E	1	Right hand sidearm
E1	10	M10x1.5x30 Bolts, 2 Nuts, Lock Washers and Flat Washers (25mm O.D.)
F	1	Left hand cleat
G	1	Right hand cleat
H	6	M12x1.75x40 Bolts, Nuts and Lock Washers and 2 Flat Washers (25mm O.D.)
EP	1	Electrical Plate (ZEP2)
ZQ	1	Quantum Detachable Illustrated

FITTING

1. Remove bumper and plastic under tray. Remove and discard the 2 chassis end cones (retain 2 of the bolts (X)), release the rearmost exhaust hanger rubber.
2. Insert Sidearms (D) and (E) into chassis ends (**Note:** the sidearms are handed, (D) has a notch cut in its forward end) and loosely secure to captive nuts using Bolts (E1) with Flat Washers, use the 2 Nuts supplied for rearmost holes. Loosely attach Cross Bar (A) to Sidearms using only the forward and rearmost Bolts (H) with the Flat Washers fitted on the outside face of chassis.
3. Fully tighten all bolts. Secure Cleats (F) and (G) to rear panel using original Bolts (X) and to Crossbar (A) using remaining Bolts (H) fully tighten bolts.
4. Fit Selected neck and Electrical Plate (EP) using separate fitting instructions.
5. Cut bumper and under tray as shown below. Refit bumper, plastic under tray and exhaust rubber.

Please refer to the vehicle specification for the trailer weight and nose limits, which **must be observed**.

Recommended torque settings: M8 - 27Nm, M10 - 53 Nm, M12 - 95 Nm, M14 - 150 Nm, M16 - 214 Nm

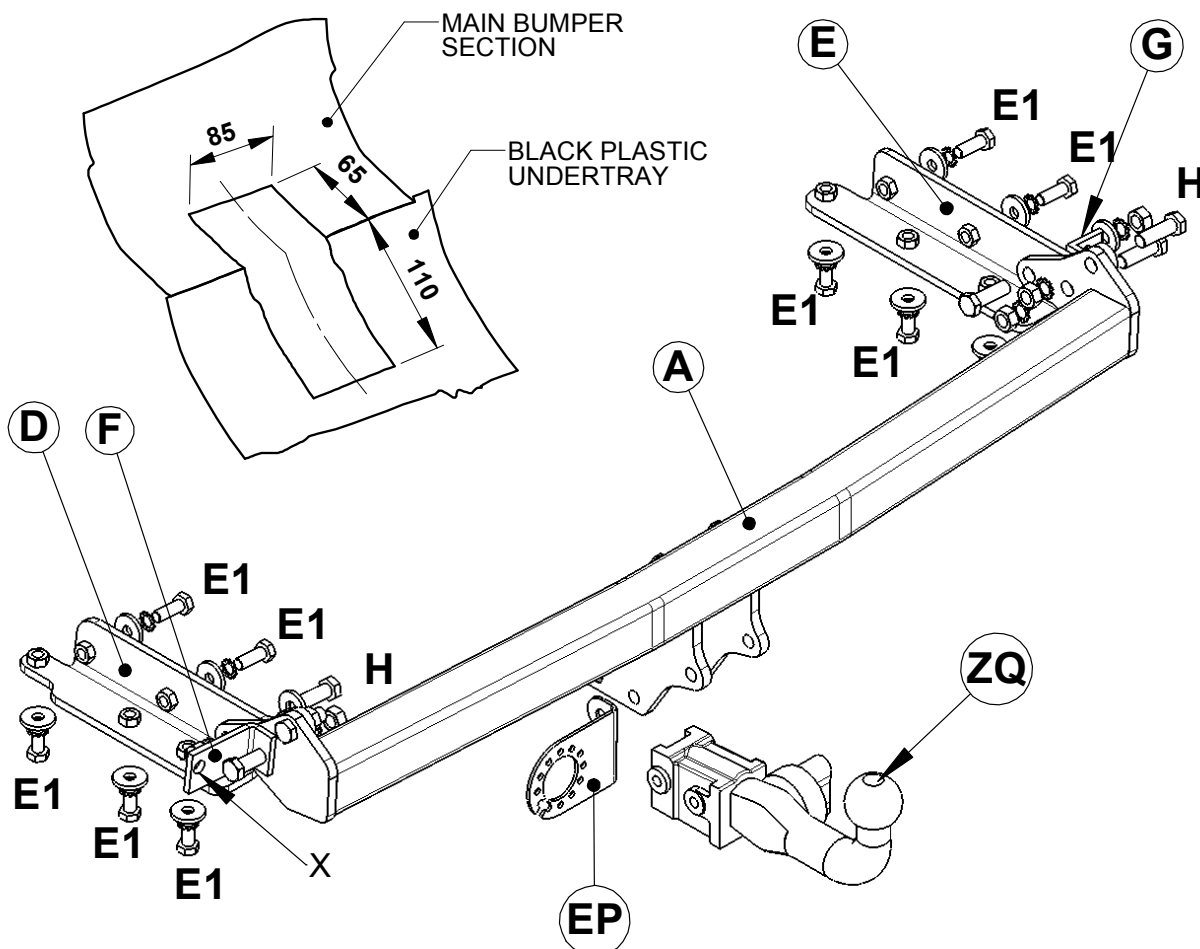

W0001DT131AU-FIT\$011105040000