

RYCO FILTERS

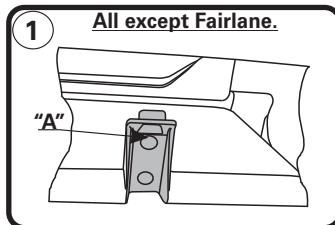

FITTING INSTRUCTIONS FOR RYCO CABIN FILTER RCA100P/C/MS



1: Place finger in channel (top centre of glove box) press down at "A", swing glove box down.

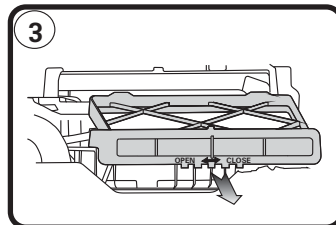

3: Remove mesh filter and discard.
or
Remove paper filter by pulling gently down and out on removal tab and discard.

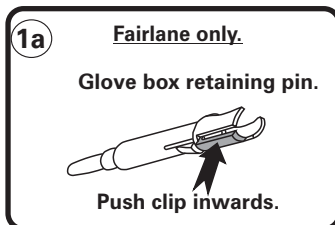

WARNING: Fairlane only. Retaining pin must be removed to remove glove box, depress clip as shown and remove. Failure to remove this pin will result in damage to pin.

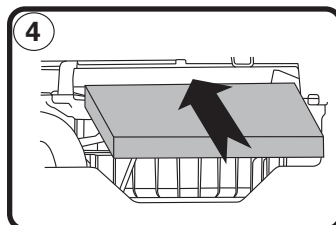

4: Slide the new filter into housing. (Position removal tab to front and on top of filter)

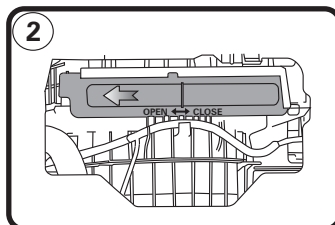

2: Slide the mesh filter or cover plate to the left to unlock.

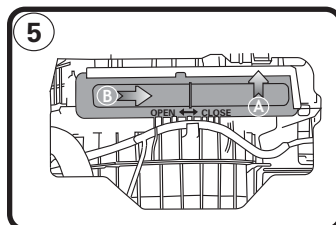

5: Install new filter cover in position, insert into the upper slot (direction A) and secure by moving the cover to the right (direction B) if fitting for first time, or use old cover. Refit all previously removed components.

GUD Automotive Pty Ltd
29 Taras Ave Altona North
Victoria 3025 Australia.
www.rycofilters.com.au

GUD Automotive -
A division of GUD (NZ) Holdings Limited
626A Rosebank Road Avondale
Auckland, New Zealand
www.ryco.co.nz

RYCO FILTERS



FITTING INSTRUCTIONS FOR RYCO CABIN FILTER RCA100P/C/MS

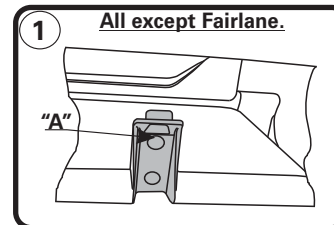

1: Place finger in channel (top centre of glove box) press down at "A", swing glove box down.

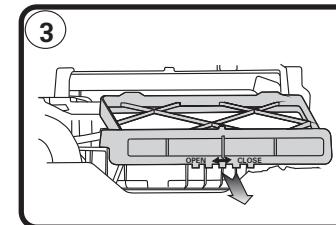

3: Remove mesh filter and discard.
or
Remove paper filter by pulling gently down and out on removal tab and discard.

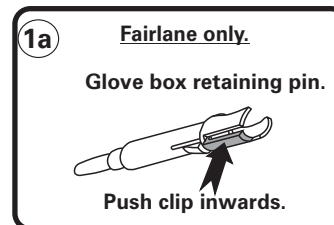

WARNING: Fairlane only. Retaining pin must be removed to remove glove box, depress clip as shown and remove. Failure to remove this pin will result in damage to pin.

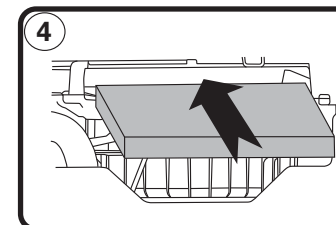

4: Slide the new filter into housing. (Position removal tab to front and on top of filter)

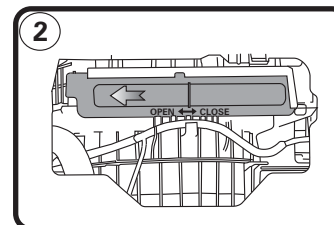

2: Slide the mesh filter or cover plate to the left to unlock.

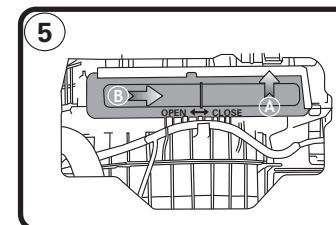

5: Install new filter cover in position, insert into the upper slot (direction A) and secure by moving the cover to the right (direction B) if fitting for first time, or use old cover. Refit all previously removed components.

GUD Automotive Pty Ltd
29 Taras Ave Altona North
Victoria 3025 Australia.
www.rycofilters.com.au

GUD Automotive -
A division of GUD (NZ) Holdings Limited
626A Rosebank Road Avondale
Auckland, New Zealand
www.ryco.co.nz