

Product Information



GAT4401

GAT4402

GAT4403

Petrol engine v6

Setting/locking tools

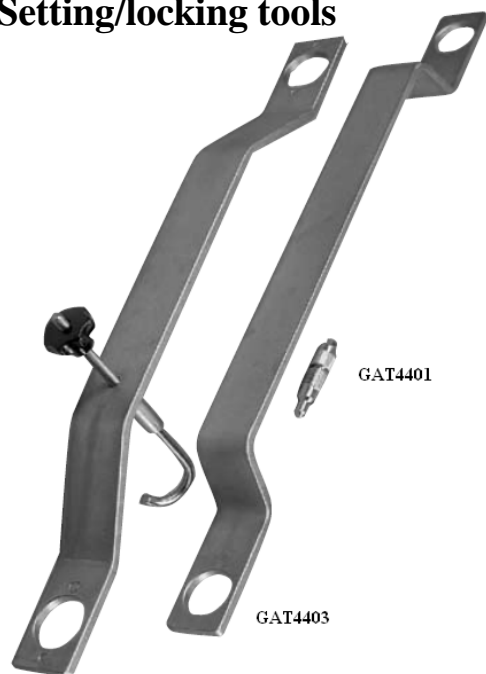

GAT4402

GAT4401 Crankshaft TDC Locking Pin

GAT4402 Camshaft Setting Plate

GAT4403 Camshaft Setting Plate

IMPORTANT: Always refer to the vehicle manufacturer's service instructions, or proprietary manual, to establish the current procedures and data. Product Information Sets detail applications and use of the tools with any general instructions provided as a guide only.

Applications:

V W GROUP V6 Petrol engines in

GAT4401 + GAT4402

AUDI

80

100

A4

A6

A8

Coupe

Cabriolet

ABC, AAH 2.6 / 2.8 engines

GAT4401 + GAT4403

AUDI

A4/S4/RS4

A6

Allroad

A8

SKODA

Superb

VOLKSWAGEN

Passat

ACK, AEJ, AGA, AGB, AGE, AHA, AJG, AIF, AIG, AGB, AJK, AIW, AML, AMM, AMX, APC, APR, APS, APZ, AQD, ARE, ARJ, ARN, ASJ, ASM, ATQ, ATX, AZA, AZB, AZR, BBG, BDV, BES

2.4 / 2.7 / 2.8 V6 engines

Additional GATES tools required:

GAT4741 Front Panel Support Guide Set (Service Position)

GAT4848 Camshaft Sprocket Remover Kit

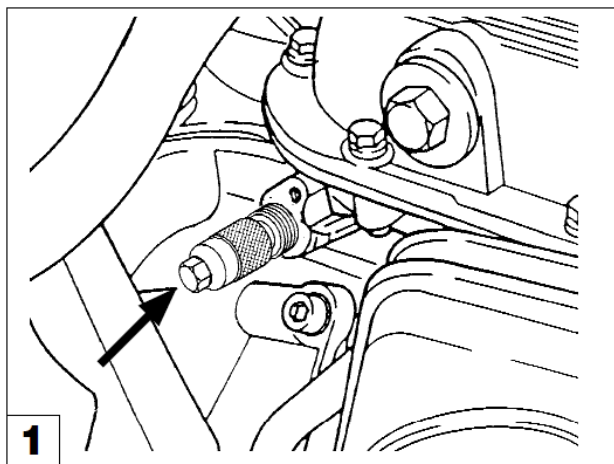

GAT4401 crankshaft TDC locking Pin

All Audi/V W V6 petrol engines detailed above, use GAT4401 Crankshaft Locking Pin to retain crankshaft TDC position, entering via a threaded hole in the crankcase and into a TDC location hole in the crankshaft web.

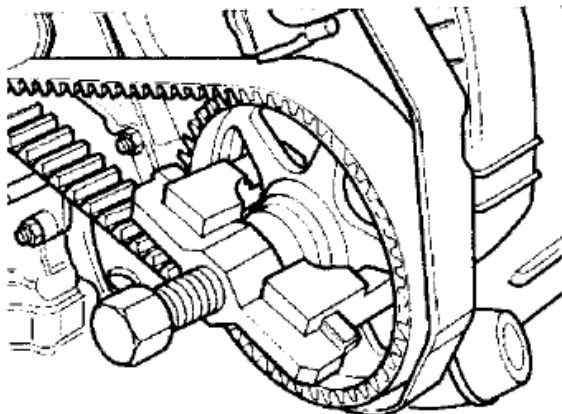

GAT4848 Camshaft Sprocket Remover - Associated Tool



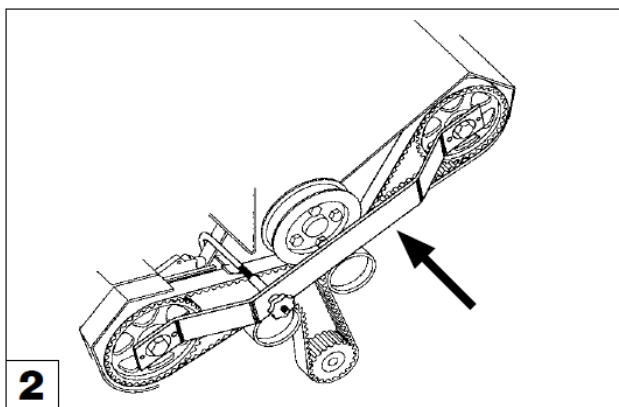

GAT4402 camshaft Setting Plate

The camshafts are 'held' in their timed position by GAT4402 Setting Plate which locates onto the camshaft fixing plates on the front of each camshaft - see Applications for details of which engines use GAT4402 Plate.

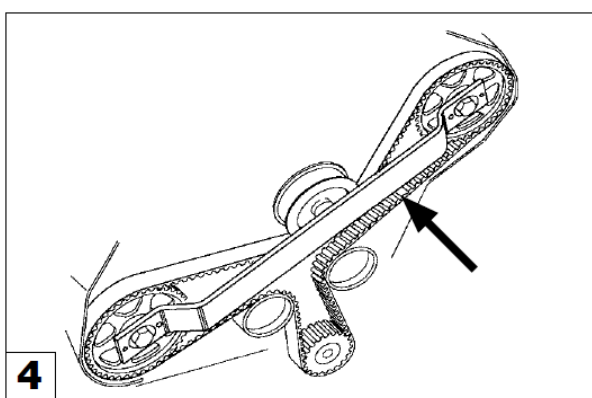

GAT4403 camshaft Setting Plate

Identical in use to the GAT4402, the GAT4403 Setting Plate retains camshaft timing position via location onto the cam sprocket fixing plates.- see Applications for details of which engines use GAT4403 Plate.

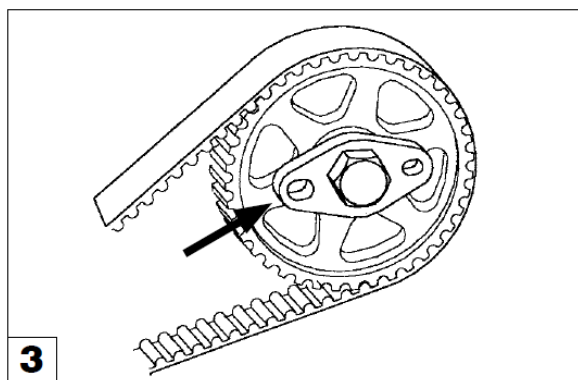

The larger holes of the camshaft sprocket fixing plates should be facing in towards each other.

The timing belt renewal procedure requires the cam sprockets to be released on their tapers, but not removed, and allowed to turn freely, but not tilt.

These engines have a belt tensioning roller which must be released and re-applied to specified torque of 4Nm. Manufacturer's belt tensioning procedure must be adhered to.

More GATES timing Kits for V W Group

Engine Setting/Locking Tool Kit 1.6-2.0
Petrol & 1.3-1.9 Diesel – see GAT4740

Engine Setting/Locking Tool Kit V6 2.5TDi – see GAT4450

Engine Setting/Locking Tool Kit
Pumpe Duse diesels – see GAT4840

Engine Setting/Locking Tool Kit
1.4/1.6 FSi (Chain) – see GAT4845

Engine Setting/Locking Tool Kit – 3.0 V6 – see GAT4940

Additional GATES tools required

GAT4741 Front Panel Support Guide Set (see below)

GAT4848 camshaft Sprocket remover Kit (see page 1)

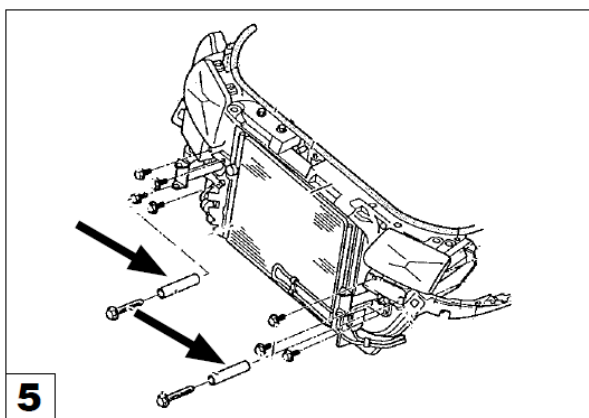

GAT4741 Front Panel Support Guide Set (Service Position) Comprises

GAT4441 Guides (Pair)

GAT4742 Guides (Pair)

GAT4743 Guides (Pair)

Audi A4 and A6 models and VW Passat and Skoda Superb require the front panel of the vehicle to be released and moved forward to provide access to the engine, for timing belt replacement (Service Position). Remove the front panel bolts, fit GAT4441 Support Guides (-01 models) or GAT4742 (01- models) and slide the panel forward.

NOTE: Remember to re-fit the upper bolts to hold panel in position.