

Electropneumatic Valves

Backstage helpers under the bonnet

PRODUCT
INFORMATION



Small and inconspicuous – but indispensable



“Backstage helpers” under the bonnet.

They are so small and unnoticeable that you have to search for them in the engine compartment. Most of them are hidden away in sections of the engine compartment that are difficult to view and to access, and where their task is often not obvious.

What switches and dimmers do in electric circuits, that's what electropneumatic valves do with high accuracy and excellent dynamics in the pneumatic system of a vehicle. In combination with a pneumatic actuator (“pressure box”), flaps and valves, such as for instance the EGR valve

or the wastegate flap on the turbocharger, can thus be actuated. Any vehicle of a more recent generation frequently even contains several electropneumatic valves.



Electric switchover valve (EUV) (highlighted) on the intake manifold of Mercedes-Benz C-Class.



Electropneumatic pressure transducer (EPW) and turbocharger in Audi A4 TDI (highlighted).



Electric pressure transducer (EDW) on an EGR valve in Opel Astra (highlighted).

Numerous electropneumatic valves are used for switching and controlling. Their field of action is everywhere anything is moved by pneumatic auxiliary energy:

- exhaust gas flaps on the rear silencer
- radiator flaps for regulating the required cooling air (diesel engine)
- diesel regulating throttles
- hydraulic engine mountings
- EGR valves
- regulation of boost pressure on turbochargers
- secondary-air valves

All solenoid valves have a high quality standard, are cost-effective and approved as original equipment by all vehicle manufacturers.

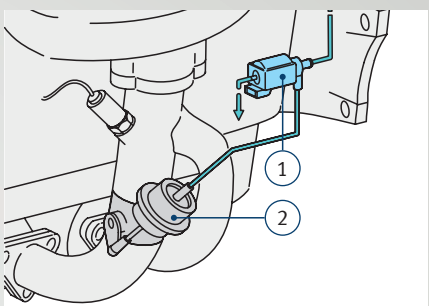
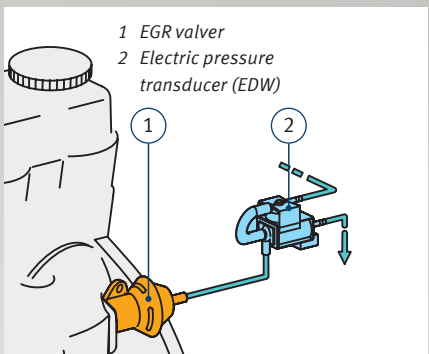

1 Electric switchover valve (EUV)
2 Exhaust gas flap

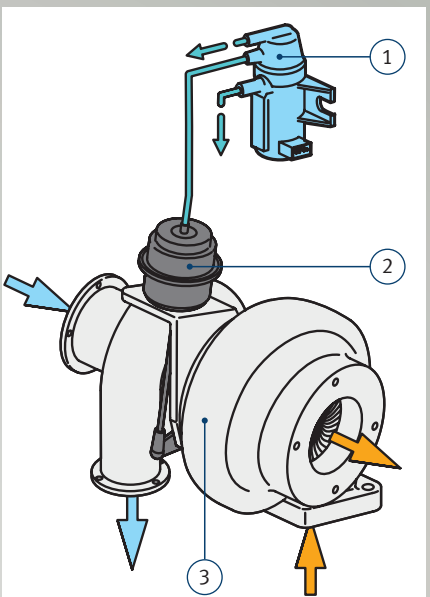

1 Electropneumatic pressure transducer (EPW)
2 Pneumatic actuator (“Pressure/vacuum box”)
3 VTG charger

And this is how you can easily find the appropriate valve:



Electric valves are immediately identifiable in the Pierburg product catalogue because of a special pictogram.



The info column also specifies the way this valve is used, for instance for actuating a turbo-charger or an EGR valve.

Numerous designations

Various vehicle manufacturers as well as valve manufacturers use quite a wide variety of designations for their components.

PIERBURG		VOLKSWAGEN	
GOLF IV			14
1.9 TDI 81 kW (110 PS)	10.1997–06.2001	7.21903.70.0	DW-AGR EP → 1J-X-999 000
AHF		7.22903.01.0	DW-AGR EP → 1J-Y-000 001→
		7.21903.75.0	DW-TL EP → 1J-X-999 000
		7.22903.04.0	DW-TL EP → 1J-Y-000 001→
		7.18221.51.0	LMS EL → 1J-X-180 000
		7.22684.08.0	LMS EL nur Fühler/only sensor
		7.24809.17.0	AGR PN
		7.24808.03.0	VP EFPR
		7.02074.15.0	WUP EL
1.9 TDI 81 kW (110 PS)	08.1999–10.2000	7.21903.75.0	DW-TL EP
AVG		7.22684.08.0	LMS EL nur Fühler/only sensor

Electric switchover valve (EUV)	Electropneumatic pressure transducer (EPW, DW)	Electric pressure transducer (EDW, DW)
<ul style="list-style-type: none">• Switchover valve• Magnetic switchover valve (VW)• Electric valves (BMW)• Solenoid valve for limiting boost-pressure N75 (VW)	<ul style="list-style-type: none">• Electric pressure transducer• Pressure transducer (VW, BMW)	<ul style="list-style-type: none">• Pressure transducer• Valve (VW)• Electric valve (BMW)

Information about our product range can be found in our catalogue “Pierburg Parts” Order-No.: 50 003 566 or via www.ms-motorservice.com

Motorservice Group

Quality and service from a single source

The Motorservice Group is the sales organisation for the worldwide aftermarket activities of Rheinmetall Automotive. It is a leading supplier of engine components for the independent aftermarket. With the premium brands Kolbenschmidt, Pierburg, TRW Engine Components and the BF brand, Motorservice offers its customers a wide and comprehensive range of top quality products from a single source. As a problem solver for trade and repair shops, the corporation also offers an extensive service package. Motorservice customers benefit from the combined technical know-how of a large international automotive supplier.

Rheinmetall Automotive

Renowned supplier to the international automotive industry

Rheinmetall Automotive is the mobility division of the technology corporation Rheinmetall Group. With its premium brands Kolbenschmidt, Pierburg and Motorservice, Rheinmetall Automotive is a global leader in the relevant markets for air supply systems, emission control and pumps and in the development, manufacture and spare-parts supply of pistons, engine blocks and plain bearings. Low pollutant emissions, good fuel economy, reliability, quality and safety are the main driving forces behind the innovations of Rheinmetall Automotive.



*** OUR HEART BEATS
FOR YOUR ENGINE.**

Motorservice Partner:

Headquarters:

MS Motorservice International GmbH

Wilhelm-Maybach-Straße 14-18

74196 Neuenstadt, Germany

www.ms-motorservice.com

